

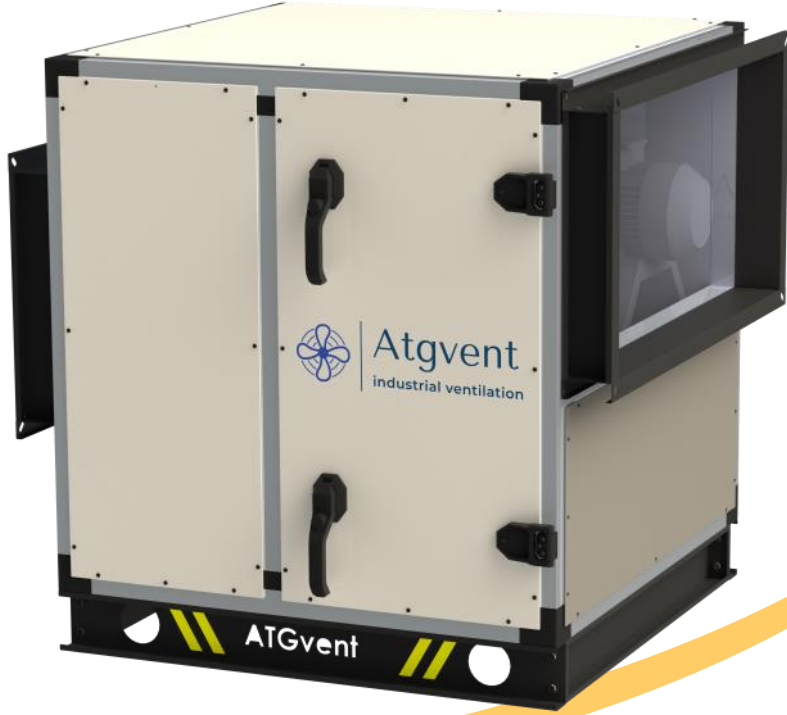

Atgvent  
industrial ventilation



CTF

Hücreli Fan



# Teknik Özellikler

Model	Debi (m <sup>3</sup> /h)	Devir (dd)	Güç (kw)	Voltaj (v)	Frekans (hz)	Ağırlık (kg)	Fiyat (dolar)
Ctf-35	2765	1365	0,55	380	50		<b>1140</b>
Ctf-40	4000	1410	0,75	380	50		<b>1320</b>
Ctf-45	5540	1440	1,1	380	50		<b>1500</b>
Ctf-50	8125	1435	1,5	380	50		<b>1720</b>
Ctf-56	11255	1445	2,2	380	50		<b>1950</b>
Ctf-63	16079	1450	4,0	380	50		<b>2280</b>

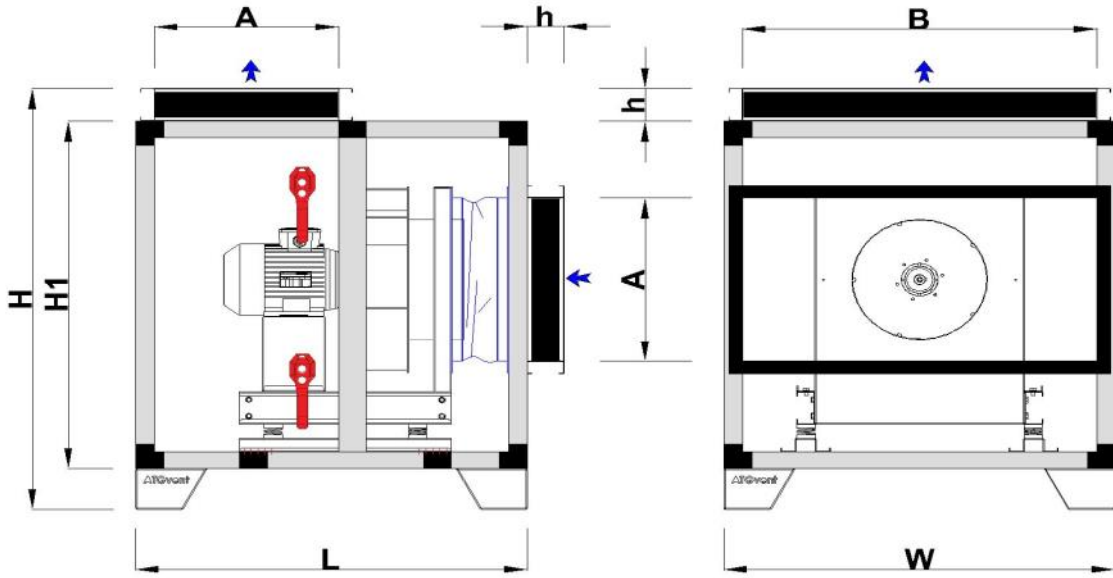

Model	L	W	H	h	a1	a2	b1	b2	c1	c2
Ctf-35	750	750	750	100	300	300	630	670	260	410
Ctf-40	800	800	800	100	350	350	680	720	260	410
Ctf-45	850	850	850	100	400	400	730	770	260	410
Ctf-50	900	900	900	100	450	450	780	820	260	410
Ctf-56	1000	1000	1000	100	500	500	880	920	265	460
Ctf-63	1100	1100	1100	100	550	550	980	1020	280	510

# Performans



	Ctf-35	Ctf-40	Ctf-45	Ctf-50	Ctf-56	Ctf-63
100 pa	2765	4000				
150 pa	2512	3733	5540	8125		
200 pa	2217	3440	5235	7804	11255	
250 pa	1865	3108	4900	7460	10890	16079
300 pa		2720	4530	7090	10510	15677
350 pa		2215	4100	6700	10110	15255
400 pa			3580	6265	9690	14823
450 pa			2885	5775	9238	14361
500 pa				5210	8740	13898
600 pa				3500	7600	12863
700 pa					6050	11657
750 pa					4890	10989
800 pa						10250
900 pa						8341
1000 pa						
1100 pa						
1200 pa						
1250 pa						



**Atgvent**  
industrial ventilation



Fatih Mahallesi, Kazımkarabekir caddesi, No:14/A Sancaktepe / İSTANBUL  
0216 3110848

[www.atgvent.com](http://www.atgvent.com)